

Start Your
Specification
Here

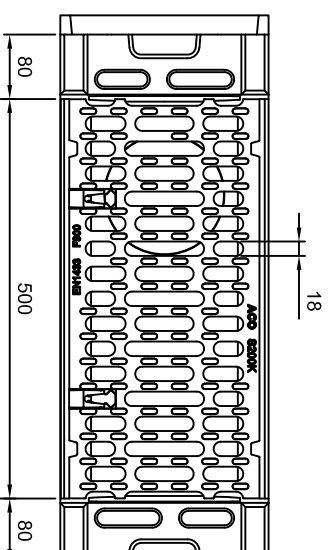
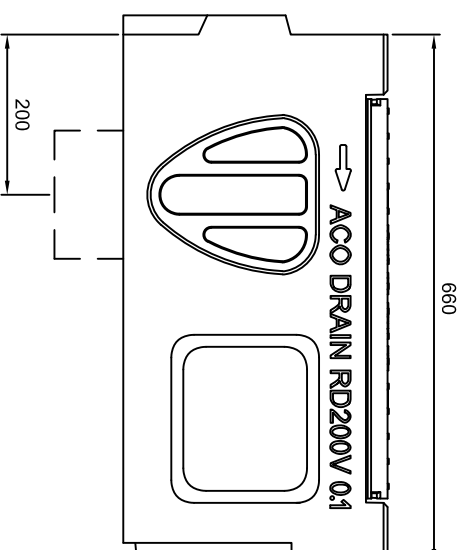
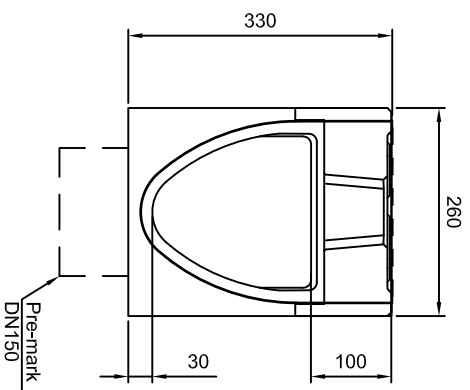

ACO MONOBLOCK RD200V 0.1 ACCESS UNIT WITH IRON SLOTTED GRATE G900						
Product	Type	Length (mm)	Width (mm)	Height (mm)	In take (mm ² /m)	Weight (kg)
Monoblock	0.1	660	260	330	93500	51,6
						130016

ACO's products include materials for civil construction with features and functions: specific technical actions for each application. Its use must be guided by projects developed by qualified professionals who consider the particularities of each project.

To meet the load classes of the projects, the foundations must have sufficient support capacity to guarantee the stability of the structure and the ACO channels must be installed according to the installation sections. For more information: please contact the Technical Department.

ACO MONOBLOCK RD200V 0.1 ACCESS UNIT WITH IRON SLOTTED GRATE - G900

Polymer Concrete Access Unit with Iron Slotted Grate (composed of the mixture of aggregates and resins) with KTL corrosion protection, Drainlock system. Load class G900. DN150 Vertical pre-mark. Male and female connections with space for sealing joints. Pre-marks on the slides to create L, T or Cross connections. With a CE certificate and full compliance with EN1433. Channel with height of 330 mm, width of 260 mm and length of 660 mm.

Rev: 10-2020

ACO DRAIN

Accessories - System
ACO MONOBLOCK

RD200V



ACO Limited

35 Te Tiki Road
Mangere, Auckland 2022
Tel.: 0800 448 080
Tel.: +64 9 815 9500
Fax.: +64 9 255 5114
e-mail: info@aconz.co.nz
web: www.aconz.co.nz

